

svan

INSTRUCTION MANUAL

Stand Fan

SVVE16P41 SVVE41R



(PLEASE READ THIS USER'S MANUAL THOROUGHLY BEFORE USING)

• Safety Instruction:

1. Never put your finger or other something into the cover to avoid any hurts.
2. Make sure to keep the fan far away from humidity, chemical articles and oil.
3. While cleaning, be sure to not splash water and do not use oil, alcohol or chemical articles as they may cause distortion of fan body and cause electrical hazards.
4. Do not pull out the power supply plug by pulling power supply cord, which may lead to electrical shock or generating electrical shock.
5. Keep away from curtain, clothing or other something may affect the fan's working.
6. Turn off all switches and pull out power supply plug when you go out for long time.
7. Never use the fan before finishing assembly to avoid any hurts.
8. If the supply cord is damaged, it must be repaired by the manufacture or its service agent or a similarly qualified in order to avoid a hazard.
9. Before sending for maintaining, if the unit doesn't work please check the plug of power supply has been inserted into socket with electricity.
10. Do not use the electric fan in rain.

• Stucture Diagram

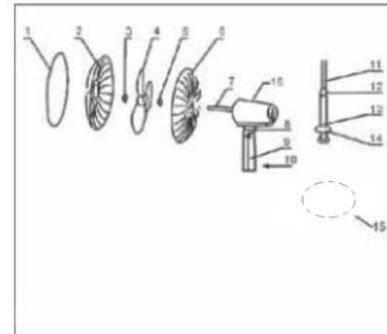

- | | |
|---------------------------|---------------------------|
| 1. Shroud Ring | 9. Back Pane |
| 2. Front Cove | 10. Screw |
| 3. Fastener for Fan blade | 11. Up-Down Tube |
| 4. Fan Blade | 12. External Joint |
| 5. Fastener for Cover | 13. Support Tube |
| 6. Back Cover | 14. Decorative Cover |
| 7. Output shaft | 15. Round Base/Cross base |
| 8. Joint | |

• Installing and Using

First step: Assemble and connect the base with assembly up-down tube and support tube.

Open the casing and take out base. Then assemble the tube and cover of up-down tube and support tube. Aim the four holes on the bottom of support tube at the holes on the base and tighten the screws. Slip decorative cover to base alongside the tube of support tube and adjust up-down tube to proper height. Then rotate tighten the external joint.

Second step: Assemble fan blade

1) Assemble guard cover and shroud ring

Tighten back cover enclosure to the motor by Fastener. (Pay attention to direction of rotation). Place joint of shroud ring downwards and cover the deep groove of shroud ring to the circle side ring of back cover enclosure. Then tighten the bolts at the position of joint properly by nut.

2) Install fan blade

While installing fan blade, please wedge groove on the back of fan blade on spacer pin of the output shaft of motor. Then tighten the fixing nut of fan blade unclockwisely.

3) Assemble front cover

Insert the circle of front cover into the groove of shroud ring, which has been fixed to the back cover. Finally fasten the bolts into screw of the joint of shroud ring.

• Direction of Use

1. Setting of wind direction

This fan can swing in up and down direction. The angle of facing upwards and downwards can be adjusted by slightly lift or press the cover.

2. Setting of shaking

Press the turning button and the head starts to rotate. Then pull it out and fan will stop rotating.

3. Setting of wind speed and wind type

Pressing button of wind speed can adjust the speed of wind.

• Solution to Simple Failure

When starting the fan, the fan blade doesn't work. Please check whether the power plug has really inserted into the socket or the cover has distorted, which has touched the fan blade. If sound the noise when starting the fan, please check the unit as follows:

- (1) Fan blade has been right installed into the output shaft of motor.
- (2) Groove on back of cover has matched the inserting groove on the output shaft.
- (3) There is tiny defective edge ring existing around the fan blade.
- (4) The cover has distorted, which has touched the fan blade.

* Maintaining and Storing

Be sure to switch off the power supply and pull out the plug before cleaning.

1. This machine only needs common external cleaning and wiping.
2. Place into casing and store in the dry position.

• Technical Parameters

Model	Rating Voltage	Rating Power	Rating Frequency	Remark
SVVE16P41 SVVE41R	220-240V	50W	50Hz	Base

SVAN TRADING S.L.

C/Ciudad de Cartagena, 20. Paterna (46988). SPAIN.

info@svanelectro.com

96060034